

# MODEL: P6034B75B\*

\*ALL ACCESSORIES OPTIONAL

## BARRIER FREE

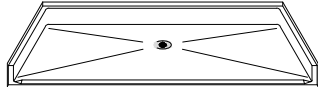

PERSPECTIVE VIEW - N.T.S.

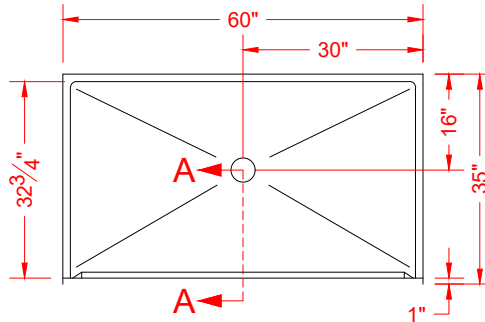

TOP VIEW - SCALE  $\frac{3}{8}'' = 1'-0''$

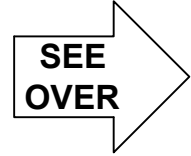

### Features:

- Molded, one-piece gelcoat/fiberglass shower pan
- Available in various Threshold heights
- On all threshold heights 1-1/4" or shorter, no mud set is required, but an adhesive kit is supplied
- On all threshold heights 1-1/2" or taller, no mud set is required

### \*OTHER THRESHOLD HEIGHTS AVAILABLE UPON REQUEST

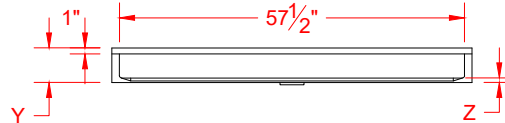

FRONT ELEVATION - SCALE:  $\frac{3}{8}'' = 1'-0''$

| MODEL #   | UNIT   | THRESHOLD |
|-----------|--------|-----------|
|           | HEIGHT | HEIGHT    |
| P6034B75B | Y      | Z*        |
| P6034B2B  | 5-3/4" | 3/4" MIN  |
|           | 7"     | 2" MAX    |

\* - SEE BACK FOR DETAIL SECTIONS

### PRODUCT SPECIFICATIONS:

- Single-piece shower pan shall be constructed of gelcoat/fiberglass
- Rough-In: Stud opening +1/4" -0" Nominal Dimensions.

C.S.I. FORMAT SPECIFICATION TEXT AVAILABLE

### PRODUCT INFORMATION:

- Colors: White as standard, others to match any major fixture manufacturer, also available with sprayable solid surface in many colors
- Custom curb heights, other than shown, are available (between min. and max.)

### OPTIONAL ACCESSORIES:

#### INSTALLED BY OTHERS:

- T-shaped rubber WaterStopper kit
- Semi-permanent threshold adapter
- No-caulk brass drain

### CODES:

- Designed and manufactured in compliance with the following standards and codes:
- ANSI Z124.2 Standards for Plastic Showers
  - ANSI A117.1 B - Accessible and Usable Buildings and Facilities
  - IPC International Plumbing Code
  - UPC Uniform Plumbing Code

### NOTICE OF LIMITATION:



*We reserve the right to make revisions without notice in the design of fixtures or in packaging unless this right has specifically been waived at the time the order is accepted.*

□ P6034B75B

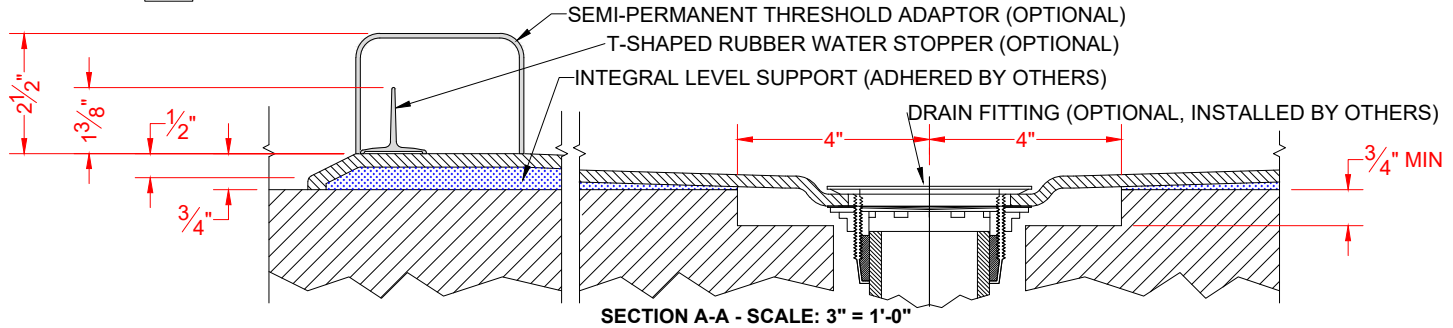

□ P6034B2B

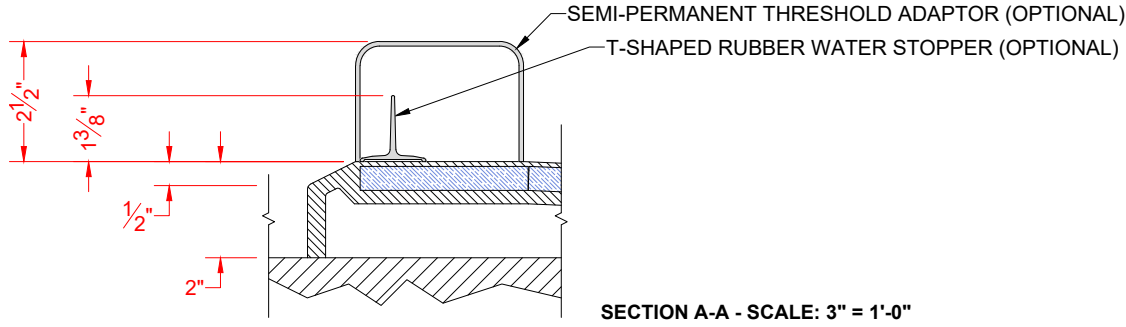

**\*\*OTHER THRESHOLD HEIGHTS AVAILABLE UPON REQUEST\*\***